

Bu-tylene Fleece Professional

Art. CP 365

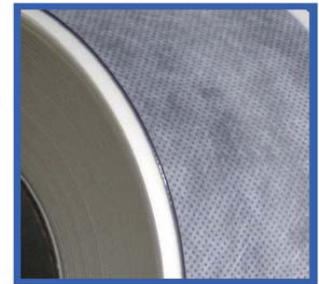
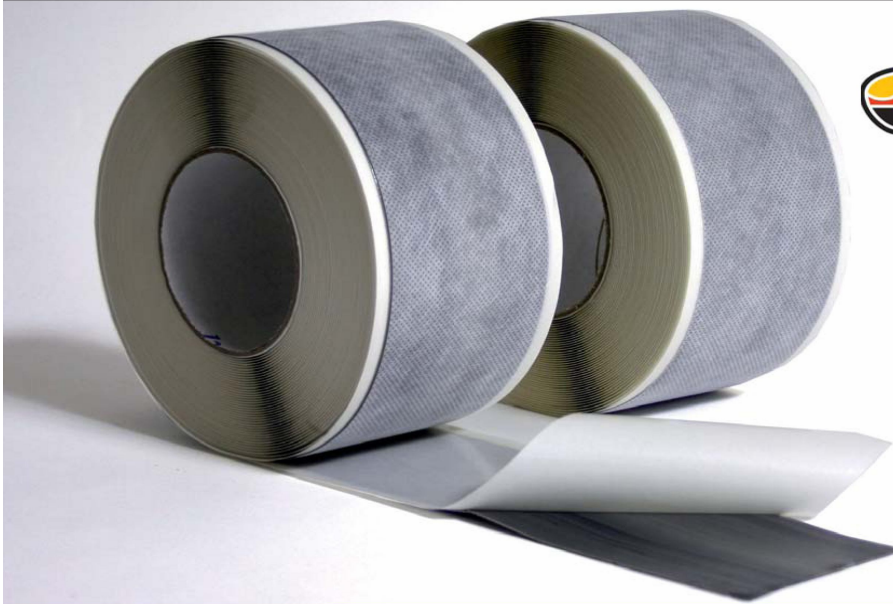

High-Adhesive Butyl Sealing Tape Self-Protected by a Polypropylene Fleece. Easy Peel.

Bu-tylene

The Product

Bu-tylene Fleece Professional is a self-adhesive sealing tape made of a butyl rubber compound self-protected by a Fleece in Polypropilene.

The tape has been developed for internal application where it is both necessary to have a high adhesion property on materials like concrete, gypsum boards or marble and featuring a finished, smooth, absorbing surface. The difference compared to the Brico range consists in the easy peel siliconized release paper: both release paper edges exceed some millimeters from the tape itself, featuring an easy removable release paper.

Bu-tylene Fleece Professional is compatible with common glues (cement and non-cement based adhesives) and it is ideal to be used under wood, marble, ceramic etc. coverings. **Bu-tylene Fleece Professional** is highly adhesive to all materials and especially to plastic, glass, steel, polycarbonate, wood and bitumen as well.

Characteristics

- High workability, plasticity and deformability;

- Excellent adhesive properties;
- Excellent heat stability;
- Excellent adhesion at low temperatures;
- Solvents Free;
- Easy Peel.

Uses

The product has been designed to seal joint between the floor slab and wall, both for bricks and gypsum surfaces. Thanks to its ease of handling, plasticity and deformability, **Bu-tylene Fleece Professional** can be used in small and reduced feasible spaces.

Surface Preparation

Bu-tylene Fleece Professional is compatible with most building materials, metals and flexible or hard plastics. The surface should be clean, dry, smooth and dust-free. If the installation surface is porous, Isoltema Primer will have to be applied in a quantity of +/- 250 gr/sqm. The use of Isoltema Primer is in any case advisable, and the manufacturers instructions must be followed because



7 Masefield Street, P O Box 40-749
Upper Hutt 5140, Wellington, New Zealand.
Ph : 64-4 527 7248, Fax : 64-4 528 4813

300 Richmond Road, PO Box 46-018
Herne Bay 1147, Auckland, New Zealand.
Ph :64-9 360 3246 Fx: 64-9 360 5081

office@hitchins.co.nz

www.hitchins.co.nz

Technical Data

Bu-tylene Fleece Professional

CHARACTERISTICS	VALUE	TEST	CHARACTERISTICS	VALUE	TEST
Standard Thickness	0.8 - 1.0 - 1.5 mm	-	Peel Adhesion 90°	> 70 N	ASTM D 1000
Compound Colour	Grey	-	Loop Tack Test	> 70 N	ASTM D 6195
Tensile Strength	long. >100 N trasv. >100 N	EN 12311-1	Vertical Flow	< 10mm	ISO 7390
Elongation at Break	long. 70 % trasv. 70 %	EN 12311-1	Cement Adhesive Strength C2E on Fleece	0.9 N/mmq	EN 12004 - EN1348
Solids	100%	-	Application Temperature	+0°C / +45°C	-
Specific Weight	1.4 g/cm3	ASTM D 792	Service Temperature	-40°C / +100°C	-

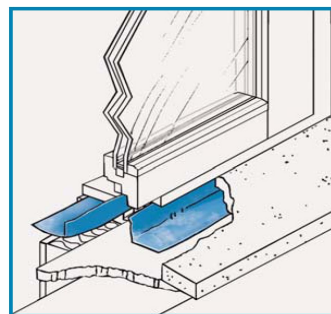
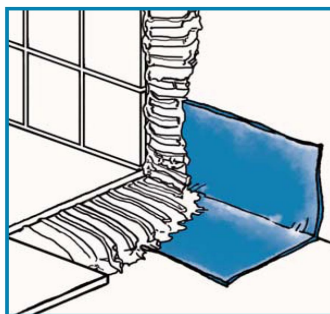

a wrong use of Primer can influence the tape efficiency.
No special tools are required to install the tape.

Installation

Prepare the surface and proceed as follows:

- Choose the most suitable width of the **Bu-tylene Fleece Professional**;
- Unroll the tape until the desired length is reached;
- Remove the silicone release film that covers the adhesive part of the tape and position **Bu-tylene Fleece Professional**;
- Press with a roller or a cloth pad.

Important Notes

Storage The quality and the characteristics of materials remain unaltered for a very long time.

It is however best to use the product within 12 months.
For correct storage, a dry, covered place is best at a temperature between +5°C and +40°C.

The product is not affected by frost.

Caution and Safety The materials is not hazardous for normal uses and when used by skilled persons.
In particular conditions, it is possible to cut or injure oneself.
Keep out of reach of children.

For further information refer to the Safety Data Sheet.

Classification for transport: Not Applicable.

Inflammability classification: M1 (UNE 23727:1990 - UNE 23721:1990).

Reaction to fire: E (EN 11925 - 2; EN 13501 - 1).

The manufacturer disclaims all liability for product use and applications.

No generic guarantees can be provided, even if the instructions indicated on this sheet are followed.

Dimensions and Packaging

Standard Lengths: 40 mt x 0.8 mm thickness;
30 mt x 1.0 mm thickness;
25 mt x 1.5 mm thickness;
18 mt x 2.0 mm thickness.

Standard Widths: 50 - 60 - 75 - 100 - 150 - 400 mm.

Other widths, lengths and thicknesses are available on request.

The rolls are manufactured following the **Easy Peel Professional system**: the siliconized film exceeds at both edges from the butyl compound, making it easy to detach.

The rolls are individually packed, placed in boxes and packed on pallets.

The figures shown on this product leaflet can vary within a tolerance of +/-5%.
The manufacturer reserves the right to change product characteristics at any time without prior notice.



7 Masfield Street, P O Box 40-749
Upper Hutt 5140, Wellington, New Zealand.
Ph : 64-4 527 7248, Fax : 64-4 528 4813

300 Richmond Road, PO Box 46-018
Herne Bay 1147, Auckland, New Zealand.
Ph :64-9 360 3246 Fx: 64-9 360 5081

office@hitchins.co.nz

www.hitchins.co.nz